

1 |

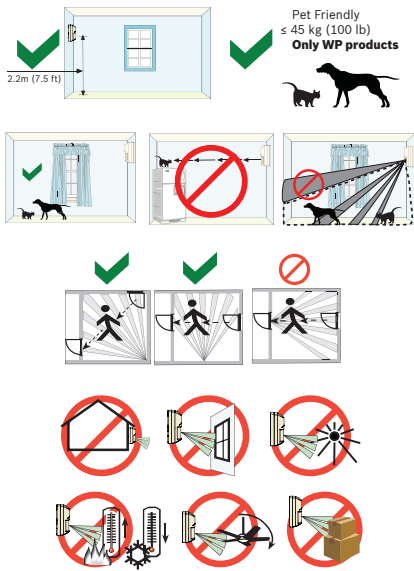

2 |

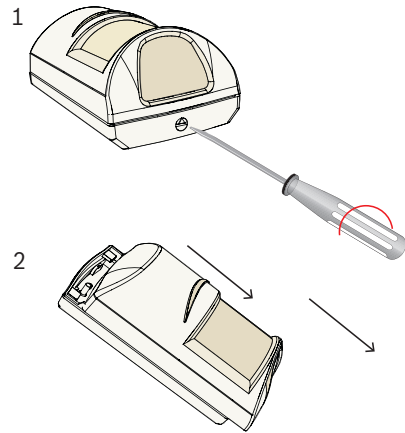

3 |

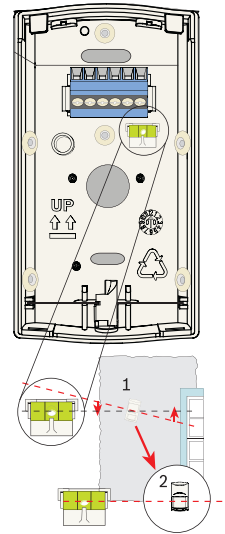

4 |

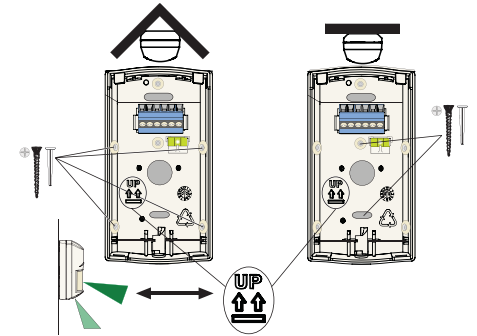

5 |

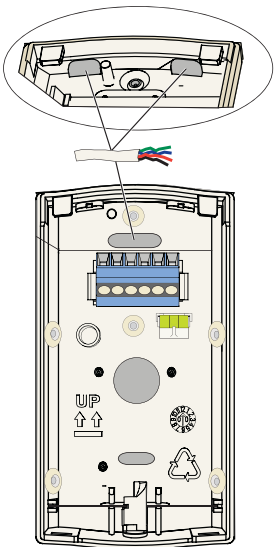

6 |

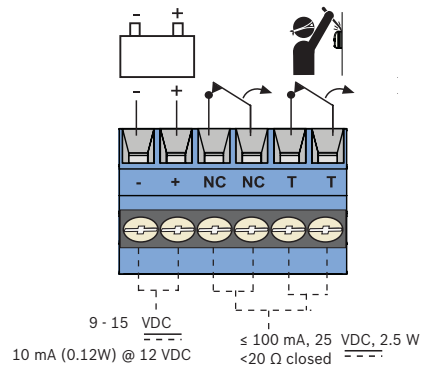

7 |

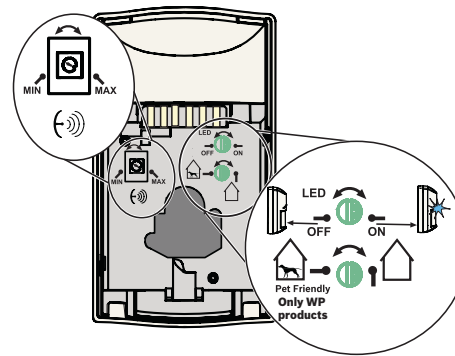

8 |

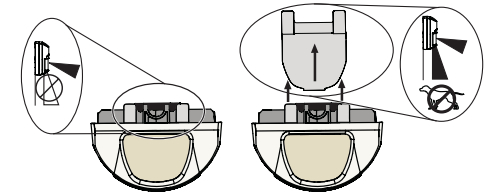

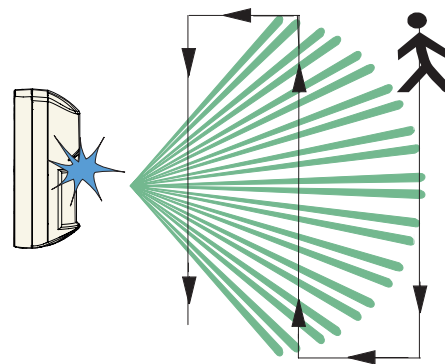
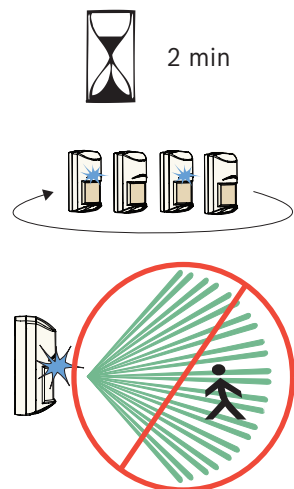
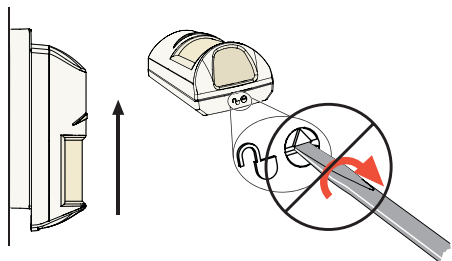

### Blue Line Gen2 TriTech Motion Detector

ISC-BDL2-W12G ISC-BDL2-W12GE

ISC-BDL2-W12HE ISC-BDL2-WP12G

ISC-BDL2-WP12GE ISC-BDL2-WP12HE

ISC-BDL2-WP6G



en Quick installation guide

BE	HR	LL	IE	EL	MT
BG	IT	PT	LU	NL	NO
CY	IS	RO	SE	UK	SK
DE	LI	CH	AT	HU	EE
DK	LT	SI	CZ	ES	LV
FI					

ISC-BDL2-WP12HE ( ) 10.570 to 10.610 GHz  
ISC-BDL2-W12HE < 20 mW

FR UK CZ EE AT SK

ISC-BDL2-WP12GE ( ) 10.510 to 10.580 GHz  
ISC-BDL2-W12GE < 25 mW

#### Manufacturing dates

For product manufacturing dates, go to <http://www.boschsecurity.com/datecodes/> and refer to the serial number located on the product label.



CE (CE 0700) For E-Models

UL / C-UL	<p>Perform Walk Test at least once a year. Use only a Listed limited-power source. Pet immunity not tested by UL / C-UL (ISC-BDL2-WP12G, ISC-BDL2-WP12GE, ISC-BDL2-WP12HE, ISC-BDL2-WP6G).</p> <p><i>E-Models not evaluated by UL / C-UL.</i> The Listed control unit or Listed burglary power supply must provide 4 hours (40 mAh) Of standby power. Install the unit in accordance with National Electrical Code NFPA 70 and Part 1 of the Canadian Electrical code CSA C22.1. Adjust the microwave range control, if necessary, to achieve maximum range.</p>
	<p>G, GE models: -20°C to +55°C (-4°F to +131°F) HE models: +5°C to +40°C (+41°F to 104°F) UL / C-UL Listed installations: 0°C to +49°C (+32°F to +120°F)</p>
	<p>0 - 95% Relative humidity (0 - 85% UL / C-UL installations)</p>